

"D" SECTION POLE DETAIL

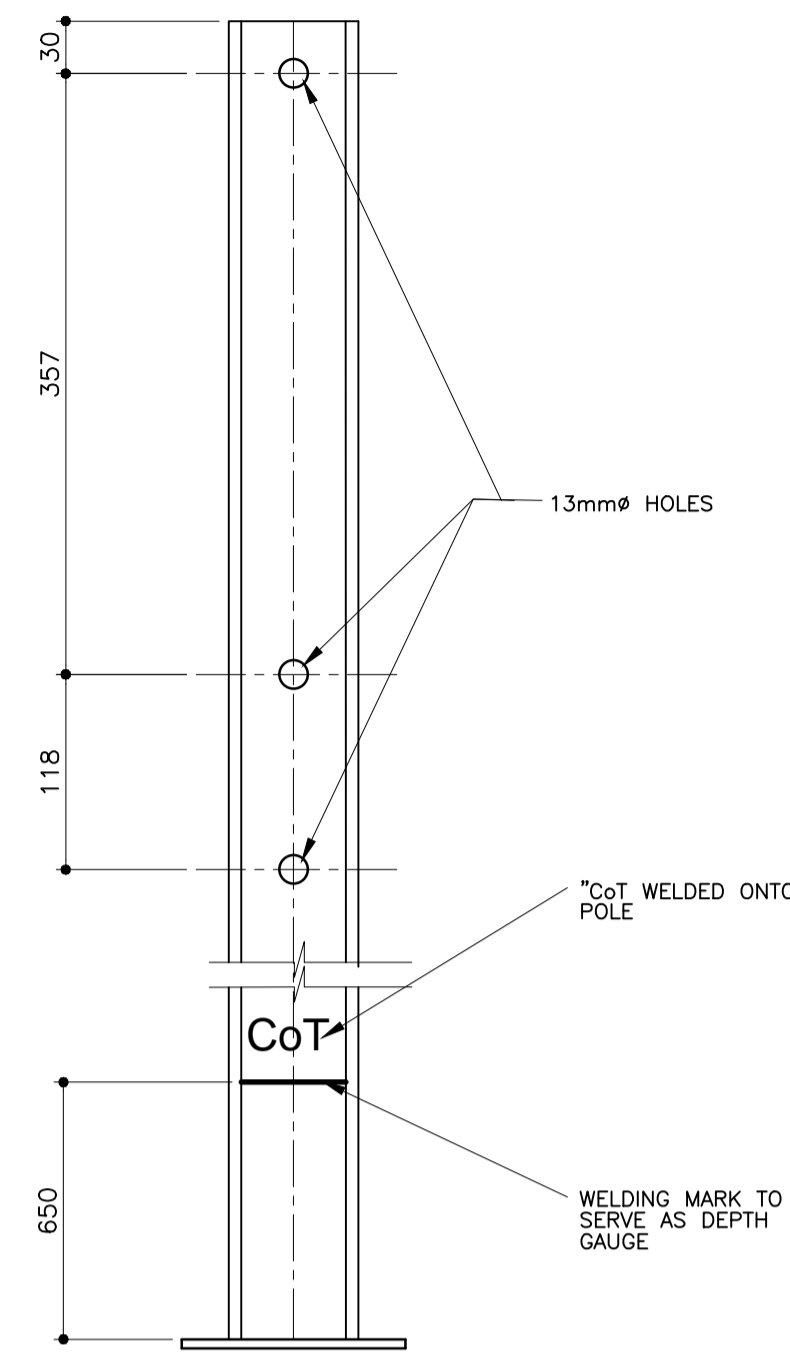

FRONT ELEVATION OF "D" SECTION POLE 3,2m & 3,6m

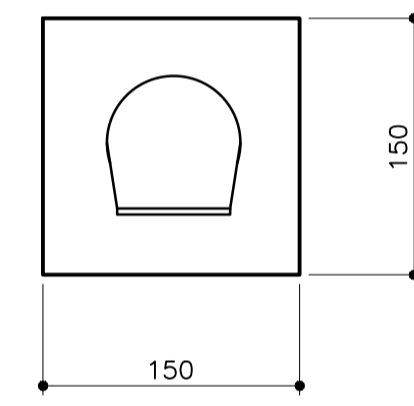

PLAN OF "D" SECTION POLE

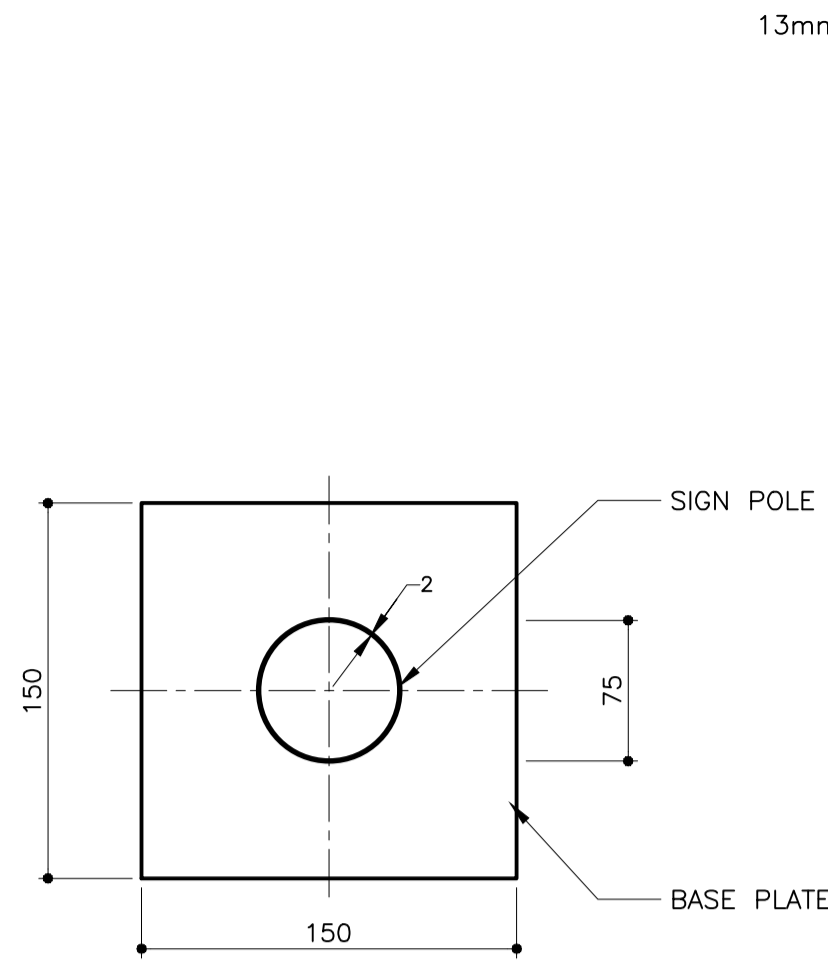

PLAN OF STREET NAME SIGN POLE

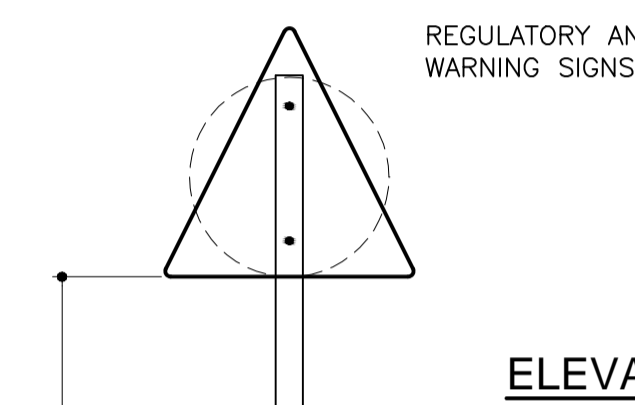

ELEVATION OF STREET NAME SIGN POLE

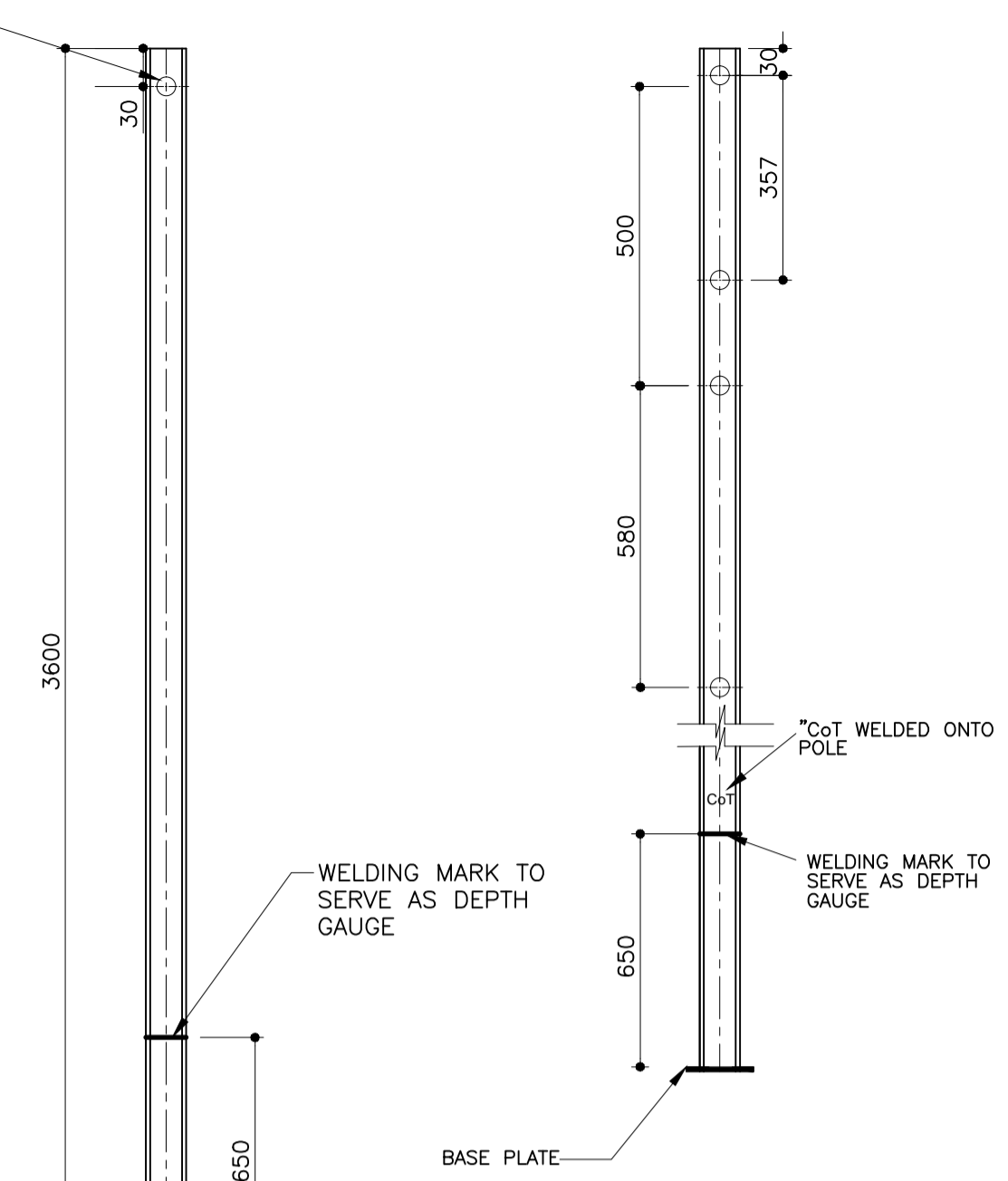

FRONT ELEVATION OF 2m & 2.5m D - SECTION POLE

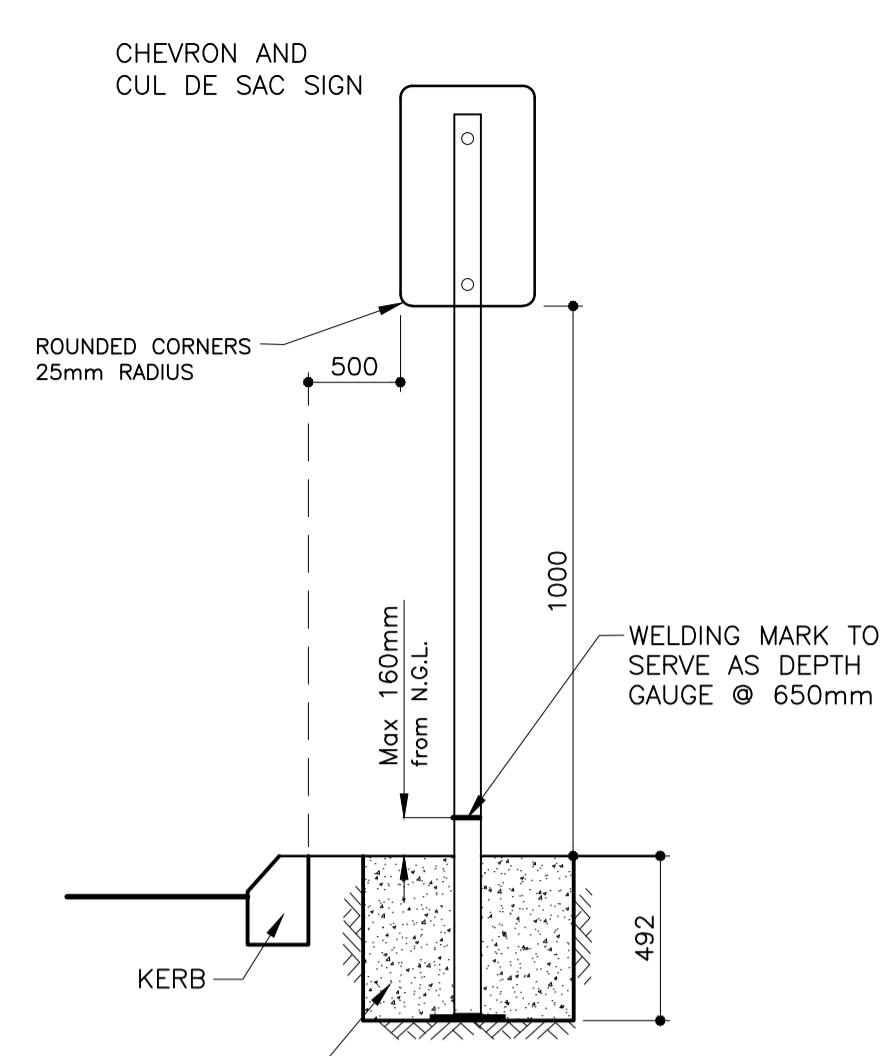

CHEVRON OR CUL DE SAC SIGN INSTALLATION DETAIL

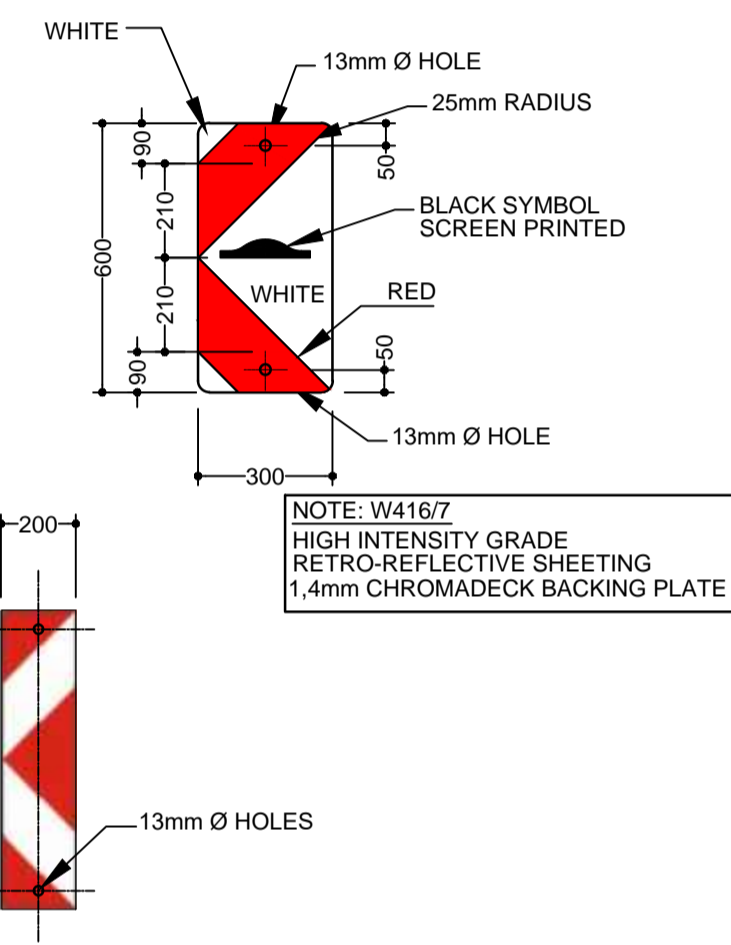

W401 & W402

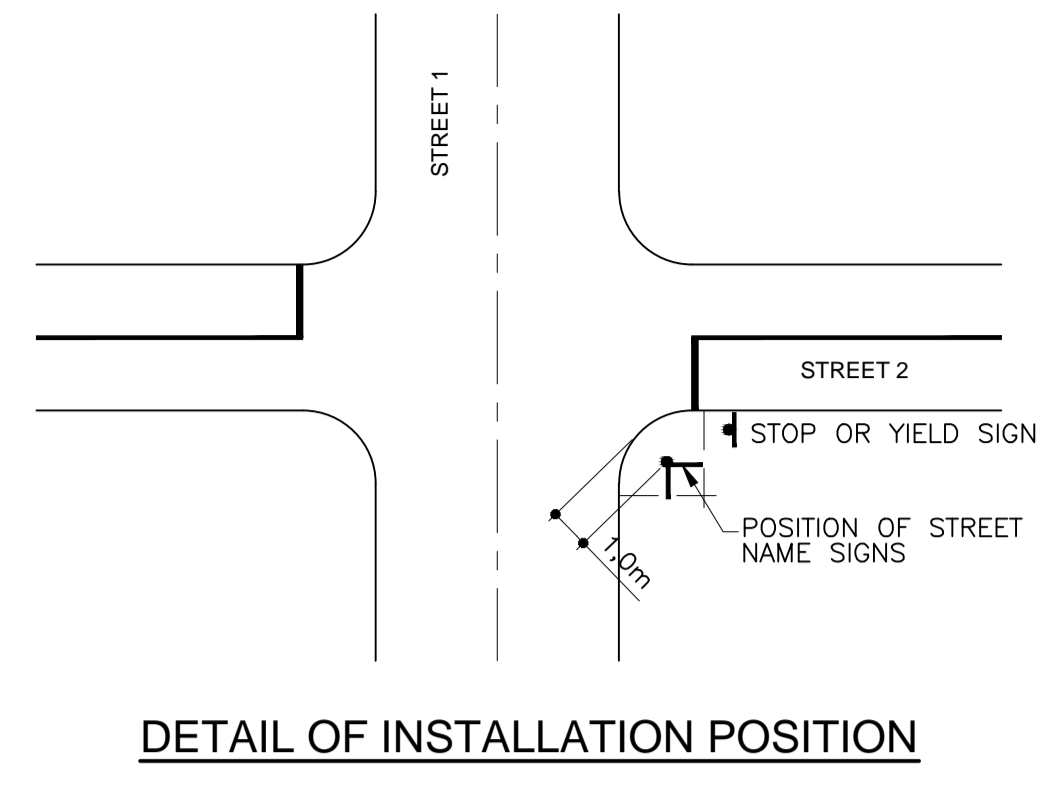

DETAIL OF INSTALLATION POSITION

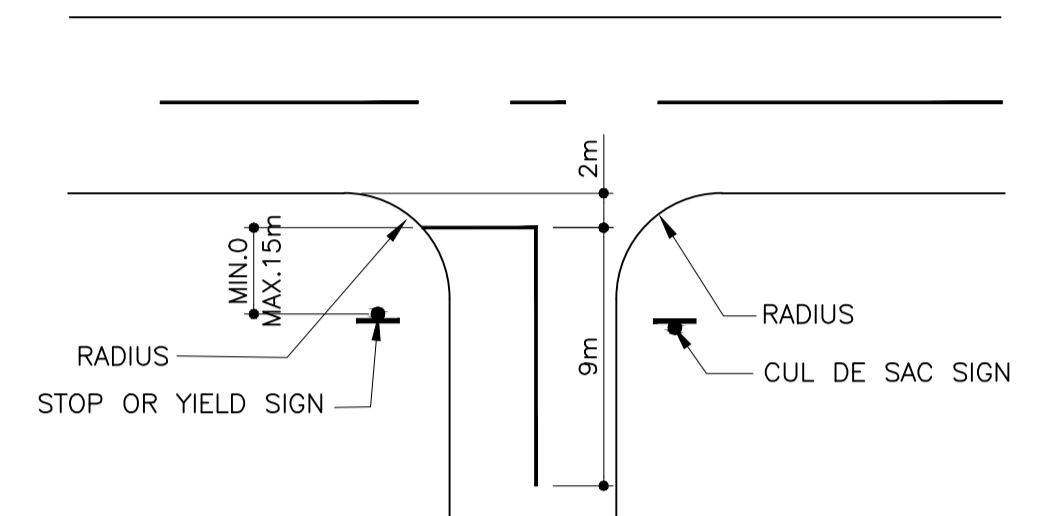

TYPICAL INTERSECTION DETAIL

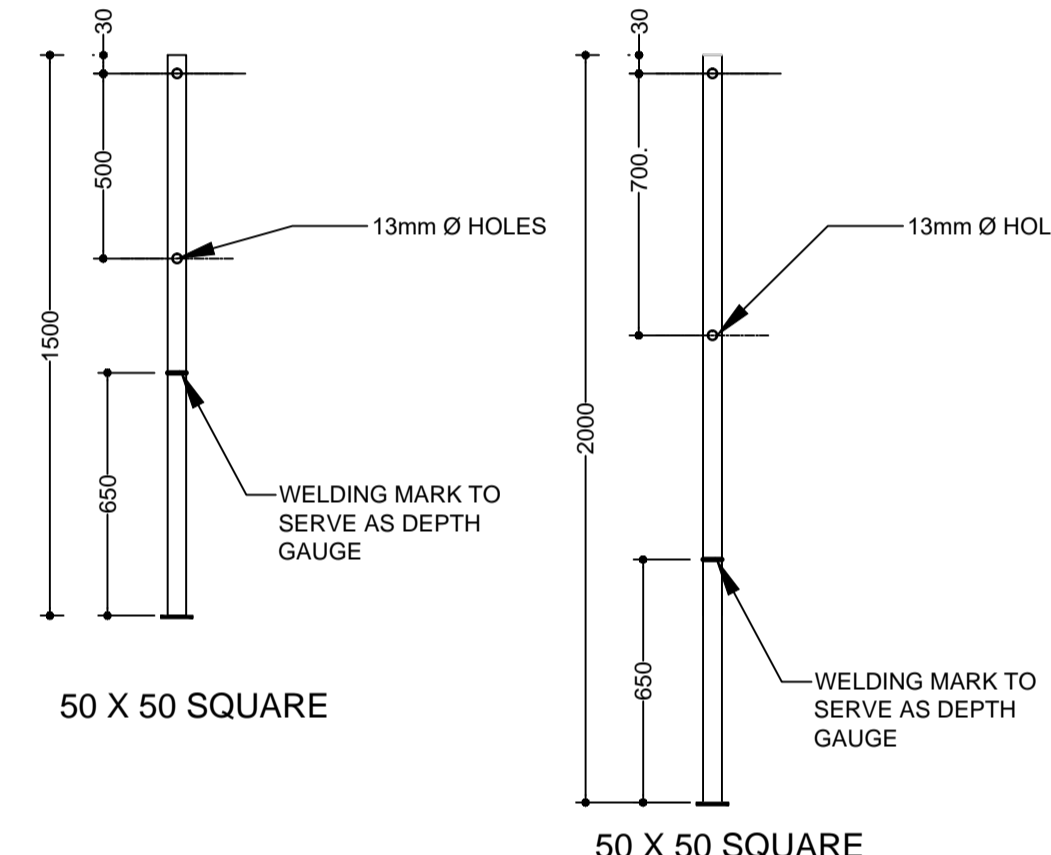

50 X 50 SQUARE

MINIMUM SIZES

SIGN	SIGN SIZE	REFLECTIVE MATERIAL CLASS	POLE SIZE
R1-R241	600mm	CLASS 1 ENGINEERING GRADE PRISMATIC	3,2m D-SECTION
R1-R241	900mm	CLASS 1 ENGINEERING GRADE PRISMATIC	3,6m D-SECTION
R1,3 & R1,4	273mm x 273mm	CLASS 1 ENGINEERING GRADE PRISMATIC	3,6m D-SECTION
R2 & R2,2	900mm	CLASS 1 ENGINEERING GRADE PRISMATIC	3,2m D-SECTION
R2,1	338mm x 450mm	CLASS 1 ENGINEERING GRADE PRISMATIC	3,6m D-SECTION
R301 - R403	450mm x 600mm	CLASS 1 ENGINEERING GRADE PRISMATIC	3,2m D-SECTION
R103 & W402	300mm x 1500mm	CLASS 3 ENGINEERING GRADE PRISMATIC	2,0m D-SECTION
R103 & W402	900mm	CLASS 1 ENGINEERING GRADE PRISMATIC	1,5m D-SECTION BREAK AWAY
W101 - W363	900mm	CLASS 1 ENGINEERING GRADE PRISMATIC	3,2m D-SECTION
W101 - W364	1200mm	CLASS 1 ENGINEERING GRADE PRISMATIC	3,6m D-SECTION
W401 - W402	200mm x 800mm	CLASS 3 HIGH INTENSITY PRISMATIC	2,0m D-SECTION
W401 - W402	250mm x 1000mm	CLASS 3 HIGH INTENSITY PRISMATIC	2,5m D-SECTION
W403 - W404	1200mm	CLASS 3 HIGH INTENSITY PRISMATIC	3,2m D-SECTION
W405 - W406	450mm x 450mm	CLASS 3 HIGH INTENSITY PRISMATIC	2,0m D-SECTION
W405 - W406	900mm x 900mm	CLASS 3 HIGH INTENSITY PRISMATIC	2,5m D-SECTION
W407 - W408	450mm x 1350mm	CLASS 3 HIGH INTENSITY PRISMATIC	2,0m D-SECTION
W407 - W408	900mm x 2700mm	CLASS 3 HIGH INTENSITY PRISMATIC	2,5m D-SECTION
W409 - W410	450mm x 2700mm	CLASS 3 HIGH INTENSITY PRISMATIC	2,0m D-SECTION
W409 - W410	900mm x 5400mm	CLASS 3 HIGH INTENSITY PRISMATIC	2,5m D-SECTION
W411	350mm x 3360mm	CLASS 3 HIGH INTENSITY PRISMATIC	2,0m D-SECTION
W413	466mm x 800mm	CLASS 3 HIGH INTENSITY PRISMATIC	1,5m D-SECTION BREAK AWAY
W415	200mm x 800mm	CLASS 3 HIGH INTENSITY PRISMATIC	MOUNT ON BRIDGE
W416 - W417	300mm x 600mm	CLASS 3 HIGH INTENSITY PRISMATIC	1,5m D-SECTION
IN4 - IN 6	450mm x 600mm	CLASS 3 HIGH INTENSITY PRISMATIC	2,0m D-SECTION
STREET NAMES	R3 & R6 & R101 - R241	CLASS 1 ENGINEERING GRADE PRISMATIC	3,2m D-SECTION
	R3 & R6 & R101 - R242	CLASS 1 ENGINEERING GRADE PRISMATIC	3,2m D-SECTION

R & W SERIES (600 & 900 SIZE SIGNS)

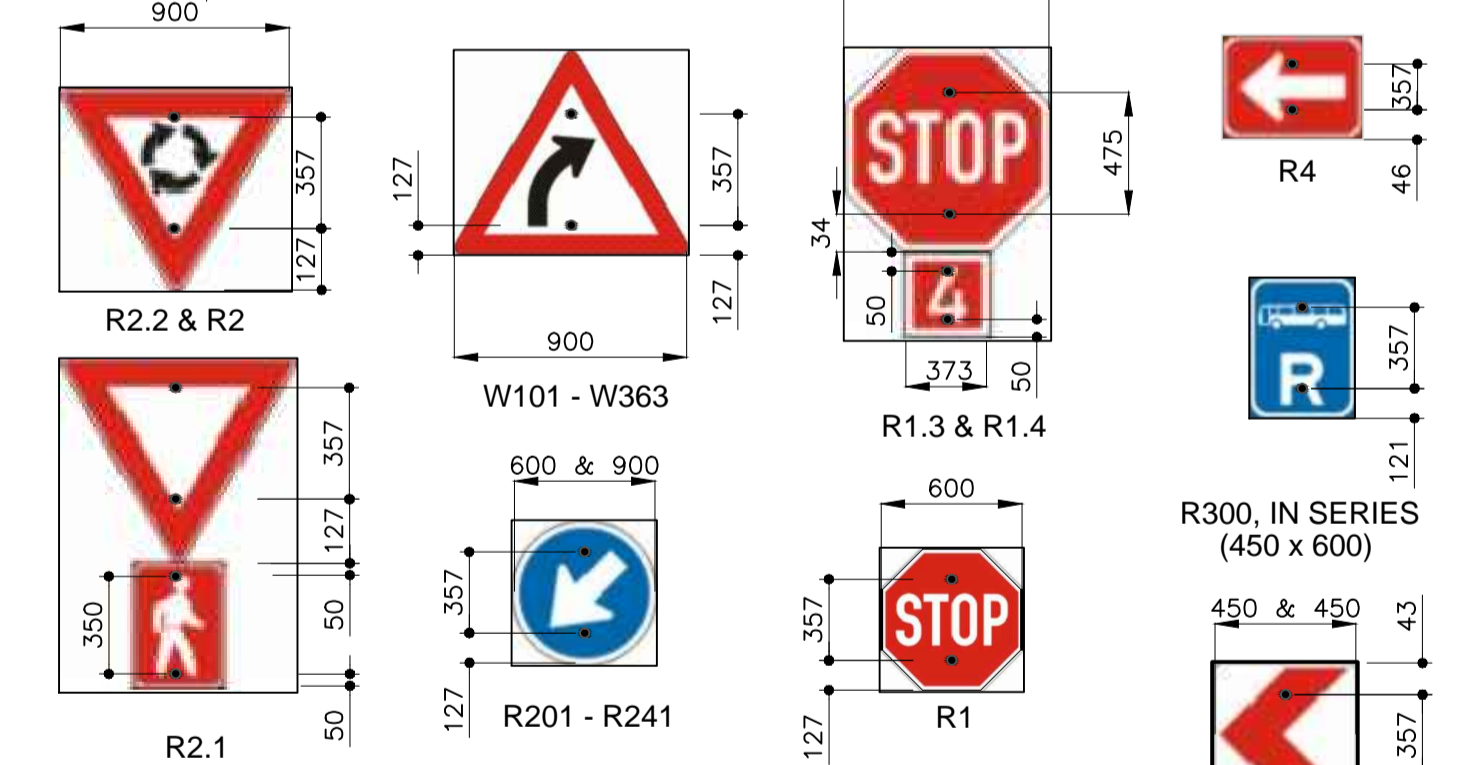

WALKWAY REGULATORY / WARNING SIGNS INSTALLATION DETAIL

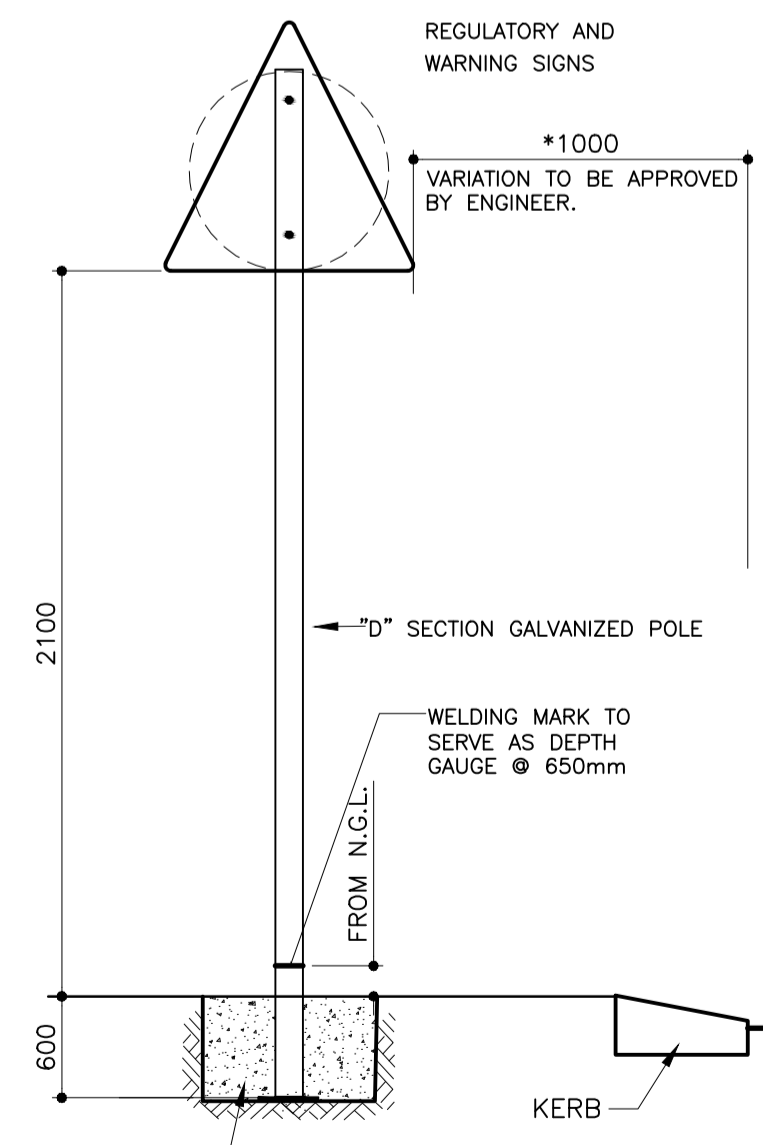

NO WALKWAY REGULATORY / WARNING SIGNS INSTALLATION DETAIL

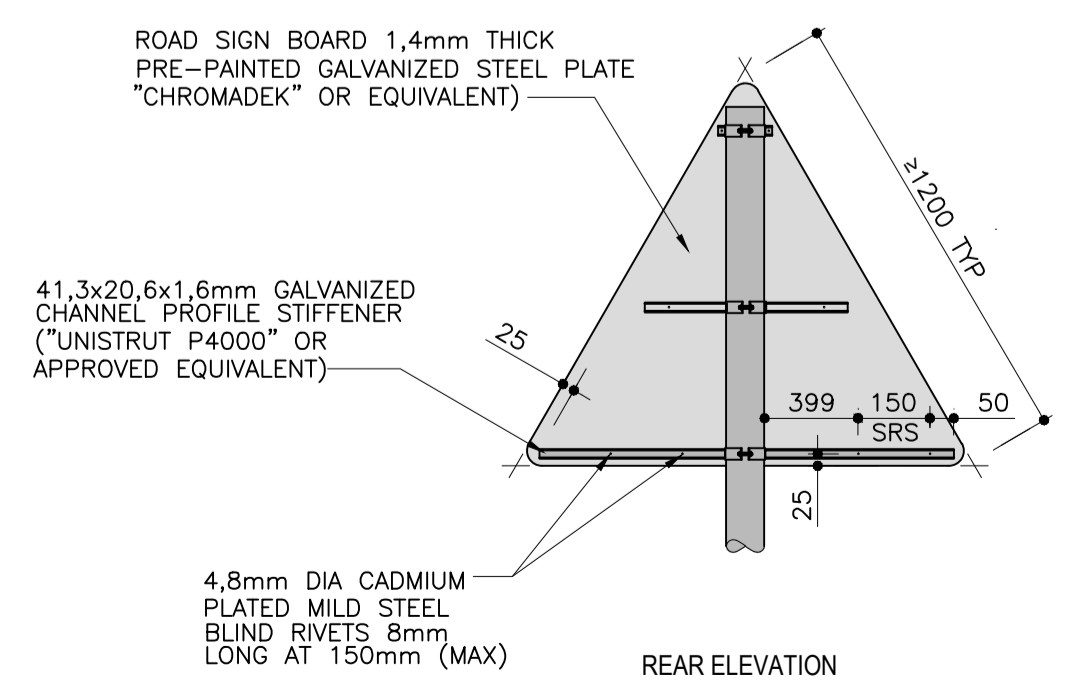

REGULATORY AND WARNING SIGNS SIGN DRILLING DETAIL (13mm Ø Holes)

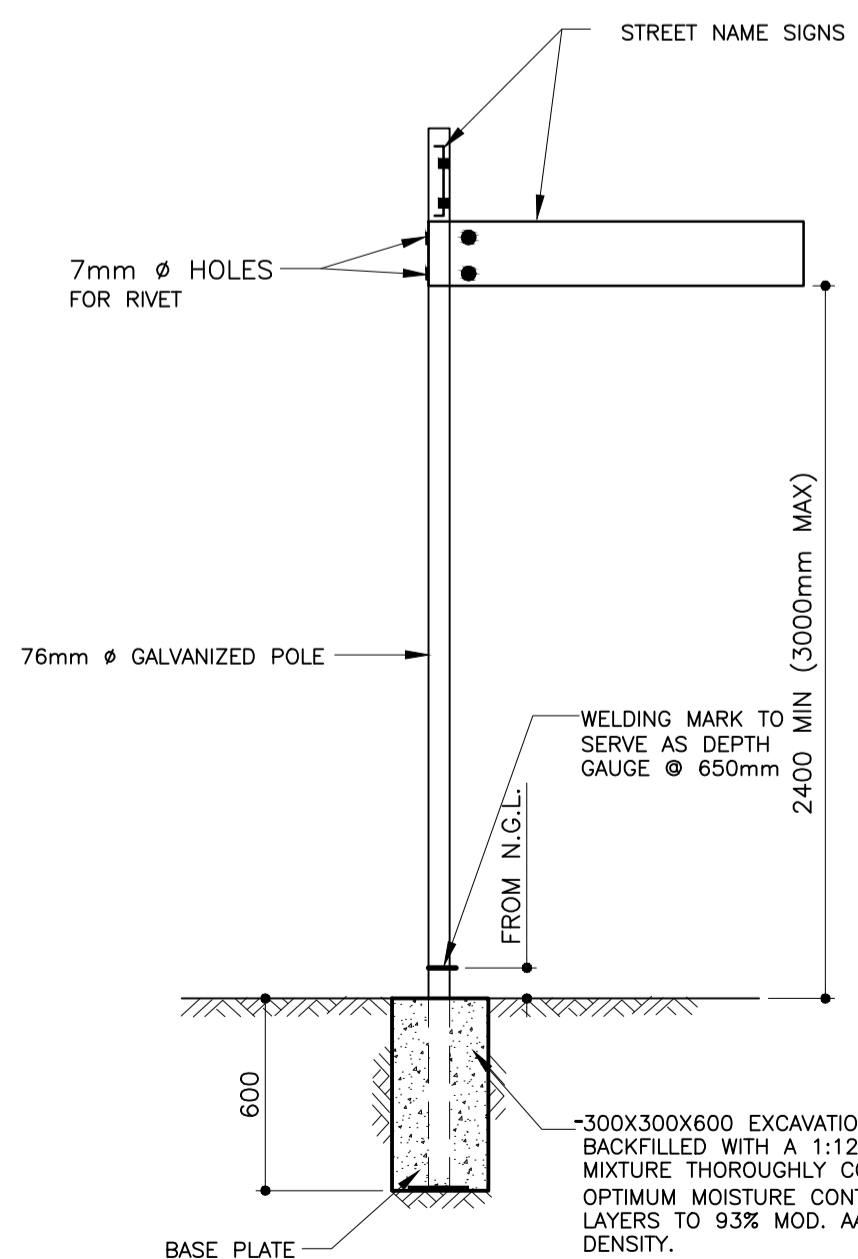

INSTALLATION DETAIL

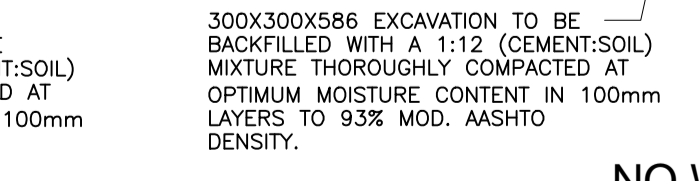

WALKWAY REGULATORY / WARNING SIGNS INSTALLATION DETAIL

NOTES AND SPECIFICATIONS

- SIGNS AND POLES**
- POLES
 - FOR STANDARD REGULATORY AND WARNING SIGNS, POLES USED SHALL BE OF A 'D' SECTION OBTAINED BY ROLLING FLAT MILD STEEL PLATE OF 2MM WALL THICKNESS TO THE DESIRED FORM, AND SEAM-WELDING IT ALONG THE ENTIRE LENGTH (THE D-SECTION EXTRUDE FROM STANDARD PIPE SECTION IS NOT ACCEPTABLE).
 - THE D SECTION MUST HAVE A FLAT BASE OF APPROXIMATELY 63MM MEASURED EXTERNALLY AND THE CIRCULAR PART AN EXTERNAL DIAMETER OF 76MM. EACH POLE IS TO BE BLANKED-OFF AT THE TOP BY MEANS OF AT LEAST 2MM MILD STEEL PLATE WELDED TO THE TOP, WITH THE SAME FORM AS THE D SECTION. THE WELDING JOINT MUST BE WATERTIGHT AND SMOOTHED OFF AFTER WELDING.
 - THE BASE PLATE FOR D SECTION POLES AND 76MM Ø ROUND POLES TO BE 150MM SQUARE AND 2MM THICK, AND WELDED TO THE BASE OF EACH POLE BY MEANS OF EVENLY SPACED WELDS, EACH NOT LESS THAN 20MM LONG. THE BASE PLATE FOR 100MM Ø ROUND POLES TO BE 200MM SQUARE.
 - THE POLES SHALL BE HOT DIPPED ZINC COATED (GALVANISED).
 - ALL POLES > 3.0M IN LENGTH TO BE 100MM Ø ROUND POLES WITH 3MM WALL THICKNESS.
 - POLES USED FOR SIGNS > 1.5M* TO BE DESIGNED IN LINE WITH SARTSM VOLUME 2 CHAPTER 15.
 - ALL POLES USED FOR STREET NAME SIGNS SHALL BE 3.6M ROUND SECTIONS AND 76MM Ø.
 - SIGNS MUST BE INSTALLED ONTO BREAK AWAY FOOTINGS ON PAVED CONCRETE ISLANDS.
 - HOLES TO BE DRILLED AS DIRECTED BY THE ENGINEER.
 - SIGN DATE NEEDS TO BE APPLICATE TO THE FRONT OF THE POLE 50mm HIGH VINYL.
 - NO JOINTING OF POLES ALLOWED.
- SIGNS**
- ALL SIGNS TO BE MANUFACTURED WITH CLASS 1 ENGINEERING GRADE PRISMATIC MATERIAL HAVING A 7 YEAR WARRANTY PERIOD, WHILE ALL HAZARD MARKERS TO BE MANUFACTURED WITH CLASS 3 HIGH INTENSITY PRISMATIC MATERIAL HAVING A 10 YEAR WARRANTY PERIOD.
 - ALL PANEL SIGNS TO BE CLASS 3 REFLECTIVE GROUND MOUNTED AND CLASS 4 REFLECTIVE FOR OVERHEAD SIGNS.
 - ALL TEMPORARY SIGNS TO BE CLASS 3 REFLECTIVE MATERIAL.
 - NO UNISTRUTS ON SIGNS ARE ALLOWED FOR 600MM R SERIES AND UP TO 900MM W SERIES SIGNS, WHILE SIGNS > 1200MM REQUIRE UNISTRUTS.
 - ALL SIGN CORNERS TO BE ROUNDED R<25MM (EXCLUDING R1).
 - ALL SIGNS TO BE FIXED FLAT AGAINST THE POLES.
 - ALL VINYL TO BE CAST VINYL WITH 10 YEAR WARRANTY FOR ROAD SIGNS.
 - ALL INK USED FOR SILK SCREENING MUST BE FROM THE SAME SUPPLIER AS THE REFLECTIVE MATERIAL.
 - SYMBOLS FOR W416/7 TO BE SILK SCREENED.
 - STREET NAME FONT TO BE DIN 'A' AS PER SARTSM VOL. 4.
 - TYPE 2 & 3 STREET NAMES >1500MM REQUIRE 2 POLES AND BRACKETS.
 - REFLECTIVE SHEET ONLY TO BE APPLIED ONTO THE VERTICAL SECTION OF THE STREET NAME PLATE.
 - NO JOINTING OF REFLECTIVE MATERIAL ALLOWED ON SIGN FACE.
 - ALL BOLTS TO HAVE WASHERS.

AMENDMENTS			
NR	DATE	APPROVED	DESCRIPTION

DESIGNED J. CRONJIE Pr.TechEng.	DRAWN S. AUDIE
CHECKED BY S. NAIDOO Pr.Tech.Eng.	INFRASTRUCTURE TECHNICAL INFORMATION MANAGEMENT D.J. CHALMERS

CITY OF TSHWANE
ROADS AND TRANSPORT DEPARTMENT

GROUP HEAD
Mr Letlorkane P. (Pheko)

DIVISIONAL HEAD
Mr Marven K Thagale

P.O. BOX 1409
PRETORIA 0001

P.O. BOX 1409
PRETORIA 0001

DESIGNER Mr Letlorkane P. (Pheko)	TRANSPORTATION PLANNING
DESIGN AND CONSTRUCTION DIVISIONAL HEAD Mr K Thagale (Marven)	DIVISIONAL HEAD Mr L. Swaneepool (Lourens)

TYPICAL STANDARD DETAILS

SIGN BOARDS
REGULATORY AND WARNING SIGNS

CONTRACT NO.:	PROJECT NO.:
DATE: 17 NOVEMBER 2022	SCALE: NOT TO SCALE
DRAWING NO. STD018	SHEET NO. 2 OF 6